

# Spare part list for SMARTCON control unit in standard design

## 1 Version with mechanical reversing contactors

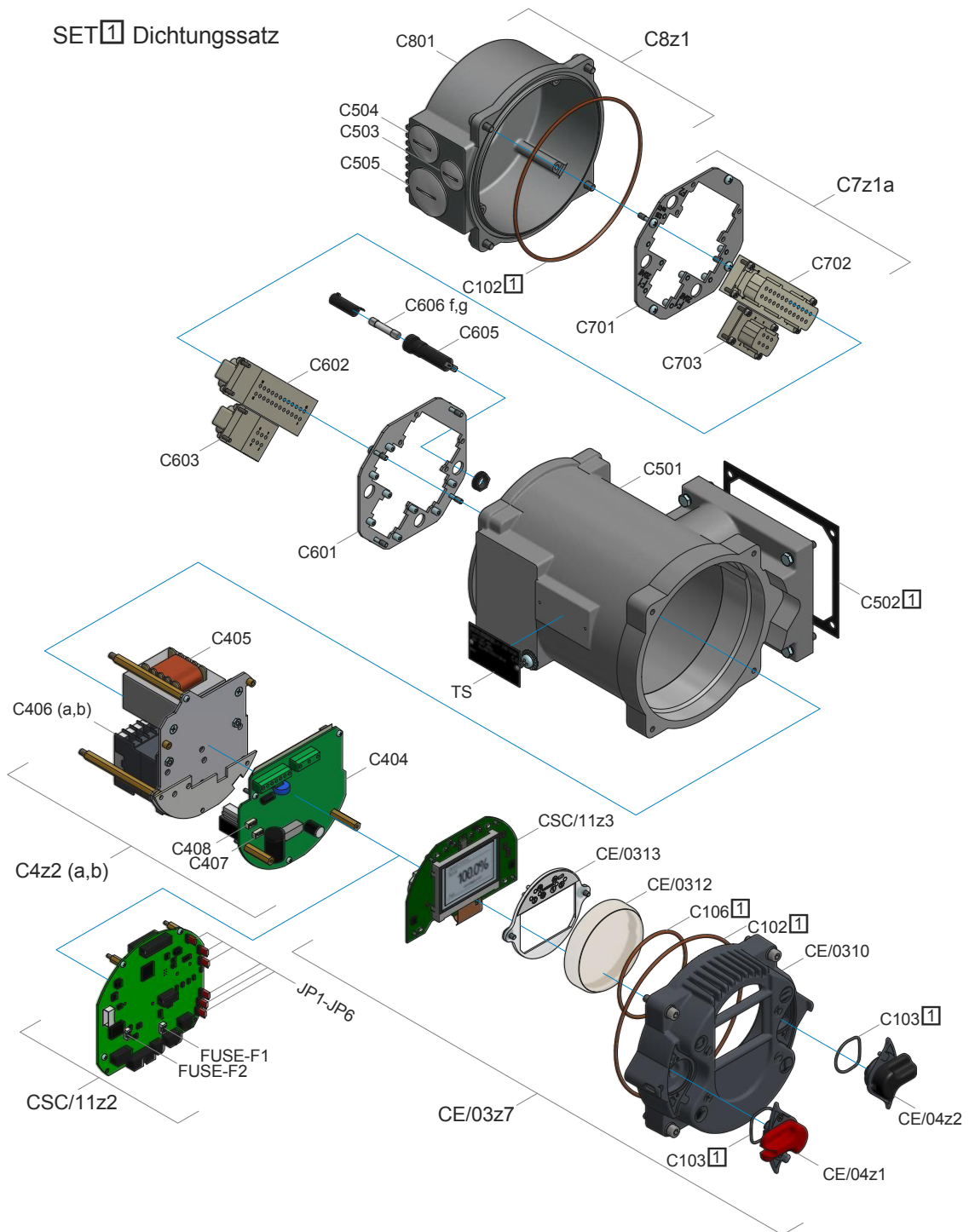

## 2 Version with thyristor reversing contactors

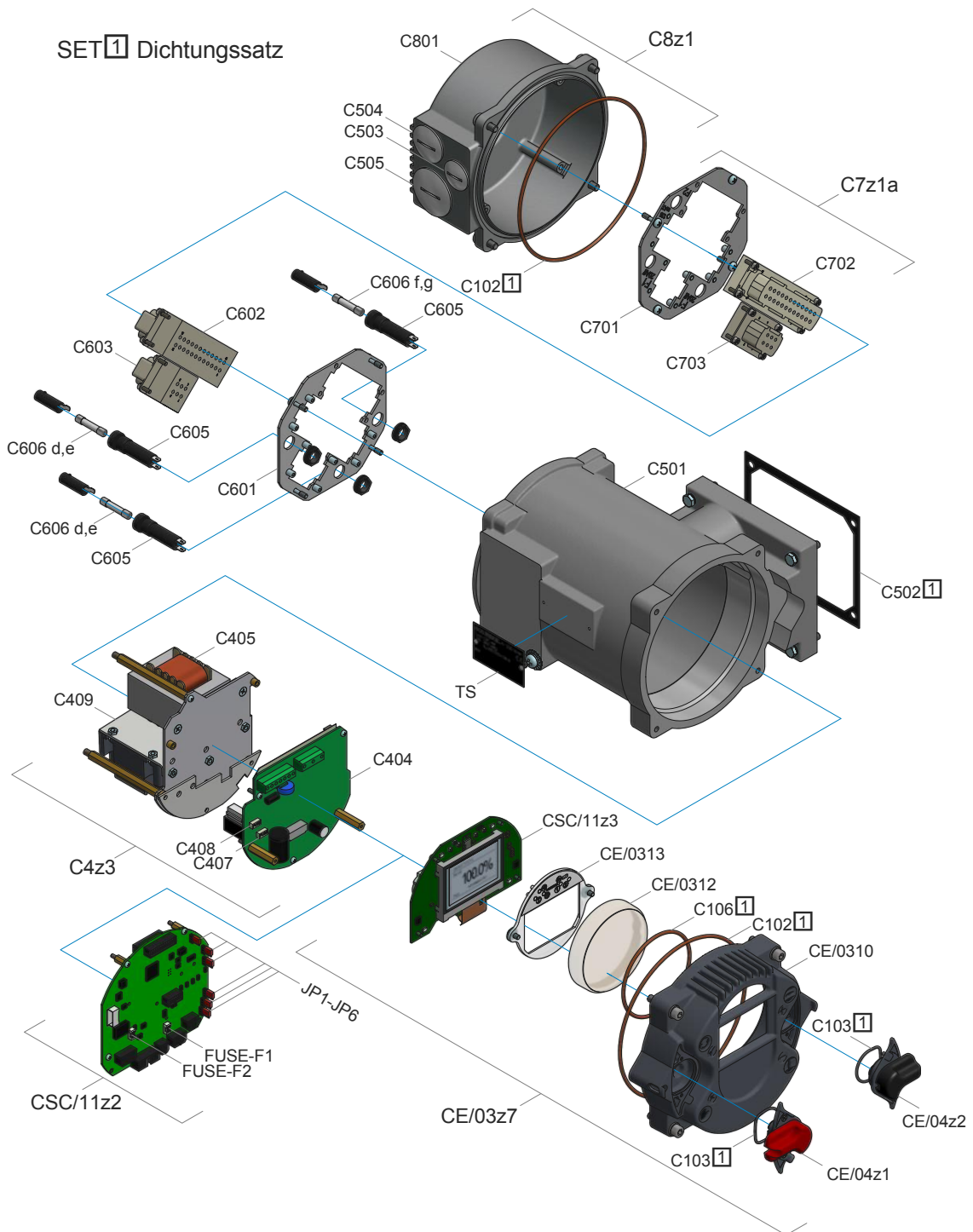

### 3 Version with Profibus and mechanical reversing contactors

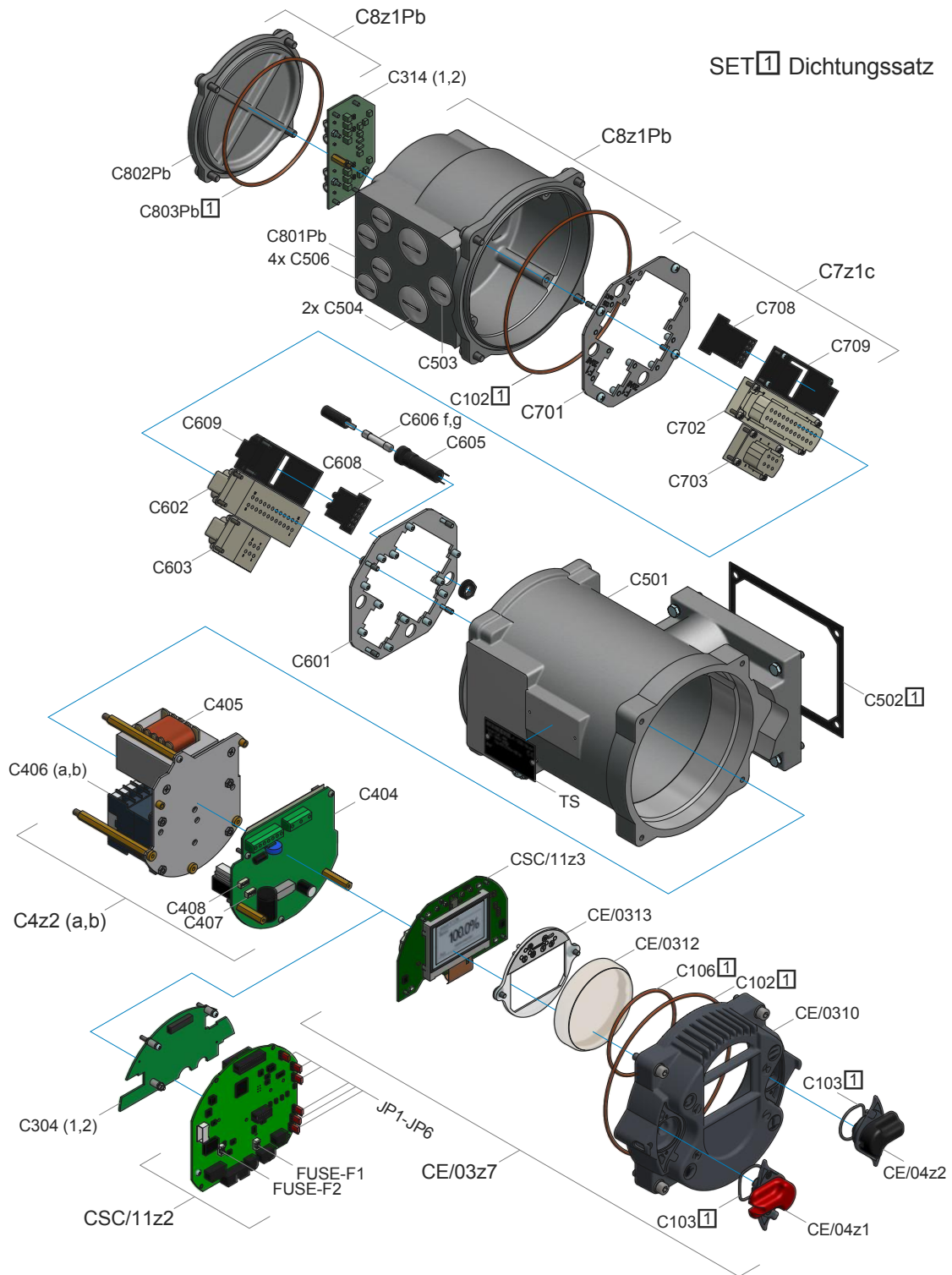

## 4 Version with Profibus and thyristor reversing contactors

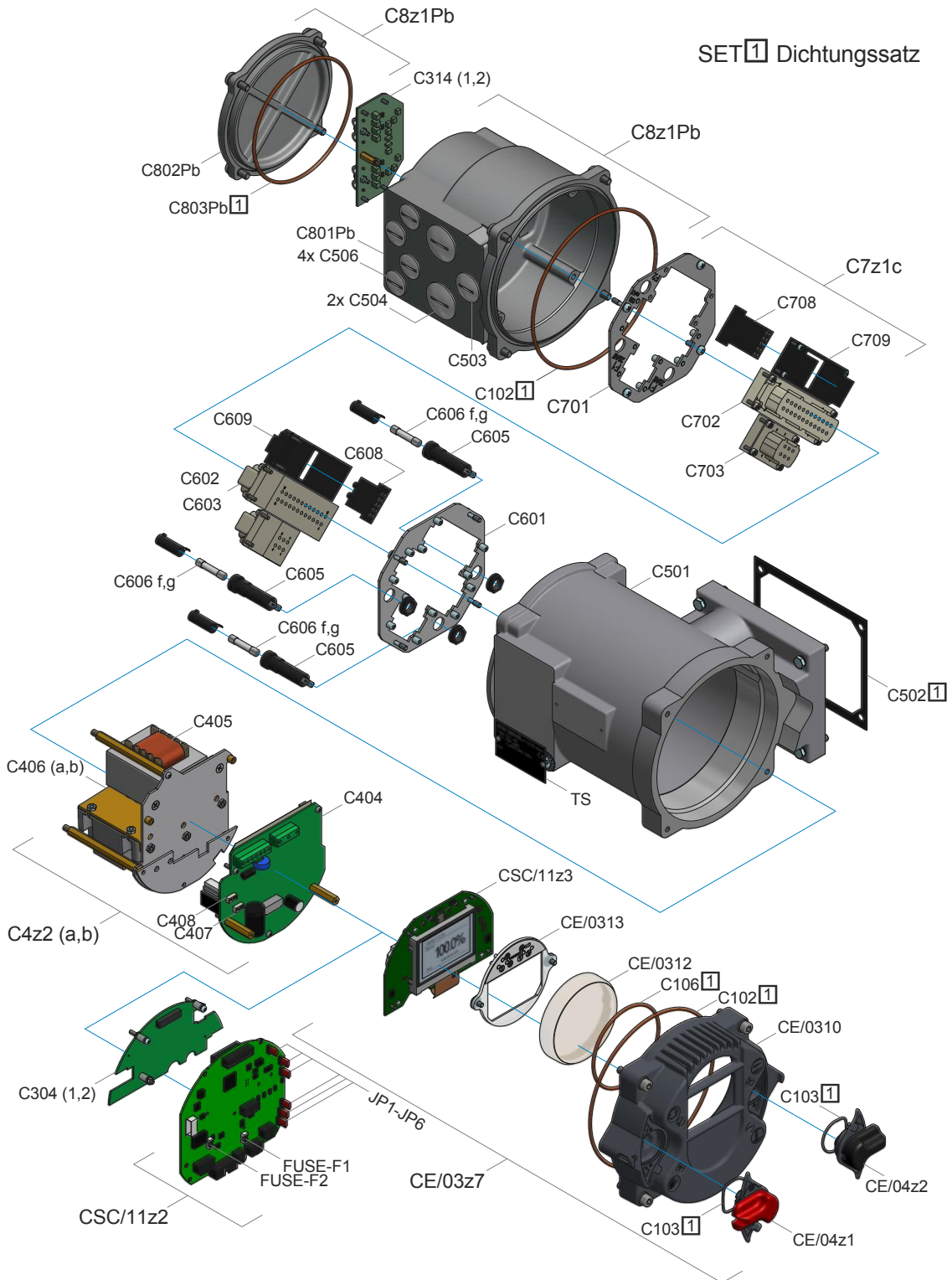

## 5 Spare part list

| Part-Nr. | Description   |
|----------|---|
| C102     | O-Ring  |
| C103     | O-Ring for operating switch red/back  |
| C104     | Operating switch black  |
| C105     | Operating switch red  |
| C106     | O-Ring inspection glass   |
| C1z1     | Cover E synthetic material complete   |
| C302a    | Fuse 375mA for Logic board  |
| C302b    | Fuse 500mA for Logic board  |
| C304-1   | Profibusprint DP1 1-channel   |
| C304-2   | Profibusprint DP2 2-channels  |
| C314-1   | Profibus connection board DP1 1-channel   |
| C314-2   | Profibus connection board DP2 2-channels  |
| C3z2     | Logic board with parametrisation accord to actuator fabrication number  |
| C404     | Basic board   |
| C405     | Transformer   |
| C406a    | mechanical reversing contactors mW4 for motor power up to 3.0kW(S2)/1.5kW(S4)                                       |
| C406b    | mechanical reversing contactors mW7K for motor power 3.0-5.5kW(S2)/1.5-3.0kW(S4)                                    |
| C407     | Fuse 1AT for Basic Board  |
| C408     | Fuse 500mAT for Basic Board   |
| C409     | Thyristor reversing contactors eW for motor power power up to 3.0kW   |
| C4z2a    | power supply unit mW4 for motor power up to 3.0kW(S2)/1.5kW(S4)   |
| C4z2b    | power supply unit mW7K for motor power 3.0-5.5kW(S2)/1.5-3.0kW(S4)  |
| C4z3     | power supply unit eW for motor power power up to 3.0kW  |
| C501     | Housing   |
| C502     | Flat gasket   |
| C503     | Nose cap M25x1.5  |
| C504     | Nose cap M32x1.5  |
| C505     | Nose cap M40x1.5  |
| C506     | Nose cap M20x1.5  |
| C601     | Mounting plate for plugs control unit   |
| C602     | Plug Han24E male for signals control unit   |
| C603     | Plug Han6E male for power supply control unit   |
| C605     | Fuse holder   |
| C606d    | Fuse 20Aff at motor power smaller 3,0kW (2.pcs per control unit)  |
| C606e    | Fuse 12,5 At at motor power =3kW (2.pcs per control unit)   |
| C606f    | Fuse 100mAT for control unit with mechanical/thyristor reversing contactors for motor power higher than 3x400V;50Hz |
| C606g    | Fuse 125mAT for control unit with mechanical/thyristor reversing contactors for motor power up to 3x400V;50Hz       |
| C608     | Plug Profibus male control unit   |
| C609     | Frame for Plug Profibus control unit  |
| C701     | Mounting plate for plug customer site   |
| C702     | Plug Han24E female for signals customer site  |
| C703     | Plug Han6E female for power supply customer site  |
| C708     | Plug Profibus female customer site  |

5 Spare part list

| Nr.      | Bezeichnung  |
|----------|--|
| C709     | Frame for Plug Profibus customer site  |
| C7z1a    | Mounting plate with plugs Han24E+Han6E customer site   |
| C7z1c    | Mounting plate with plugs Han24E+Han6E+Profibus customer site                                    |
| C8z1     | Customer cover A for connection room complete  |
| C8z1Pb   | Customer cover A type Profibus for connection room complete                                      |
| C8003Pb  | O-Ring A-cover PB  |
| CSCI-USB | SMART Interface for backup of customer datas consists of infrared dongle with cable and software |

**CAUTION:** When ordering spare parts, you **must** provide the **serial number** (look type shield near the hand lever).

Use only original spare parts supplied by SCHIEBEL. Using other parts will render the warranty void.

Illustrations may differ from actual spare parts.

